

Product Data Sheet

Astro FingerKeeper Commercial

Revision 9 - 20th April 2023



Astro Finger Keeper Commercial

Finger protection - Anti-finger trapping guard

- Astro FingerKeeper Commercial Front is a finger guard (door hinge guard) used to prevent finger trapping accidents in doors.
- Can be fitted to most types of doors including wood, metal and uPVC.
- Long anticipated lifespan and low maintenance - wipe clean finish.
- Durable but has simple DIY fitting method.
- Full fitting kit included.
- Easily removed and re-fitted to allow door maintenance.
- Various colour options to match existing décor.
- Front and Rear hinge cover versions available.
- Wide opening available in standard length 1960mm Brown & White only.
- Longer 2100mm length available Brown & White only.
- **NEW** Anthracite Grey coloured FingerKeeper Commercial.



Astro FingerKeeper Commercial Front standard shown on a closed door



Astro FingerKeeper Commercial Front standard shown on an opened door



Astro FingerKeeper Commercial Front wide shown on a closed door

Product Description

The Astro FingerKeeper Commercial device is a guard that prevents door finger trapping accidents. By totally covering the gap that is created on the hinge side of a door, in the open position, it prevents finger trapping injuries. Ideal for use in Schools, Day Care Centres, Nurseries, hospitals or any internal doors that create risk to the Public. The device is designed to create the safest working environment and avoid potentially costly and disruptive injury claims. The device is fully recyclable at end of life.

The Astro FingerKeeper Commercial device can be fitted to most types of doors including wood, metal and uPVC. The standard device is 1960mm long with a 2100mm length also available. A wide version with additional panel is available for doors which open up to 180°. The Astro FingerKeeper Commercial device is a low maintenance – wipe clean finish device. The device is extremely simple to install and has a long-life expectancy. With its screw fix design, it can be easily removed and refitted if any remedial works are needing to be completed.

For total protection from finger trapping injuries in doors see also the rear guard - **Astro FingerKeeper Rearguard**.

Product Measurements

Astro FingerKeeper Commercial Front **Standard** and **Longer** measurements - Length 3 panel (in mm):

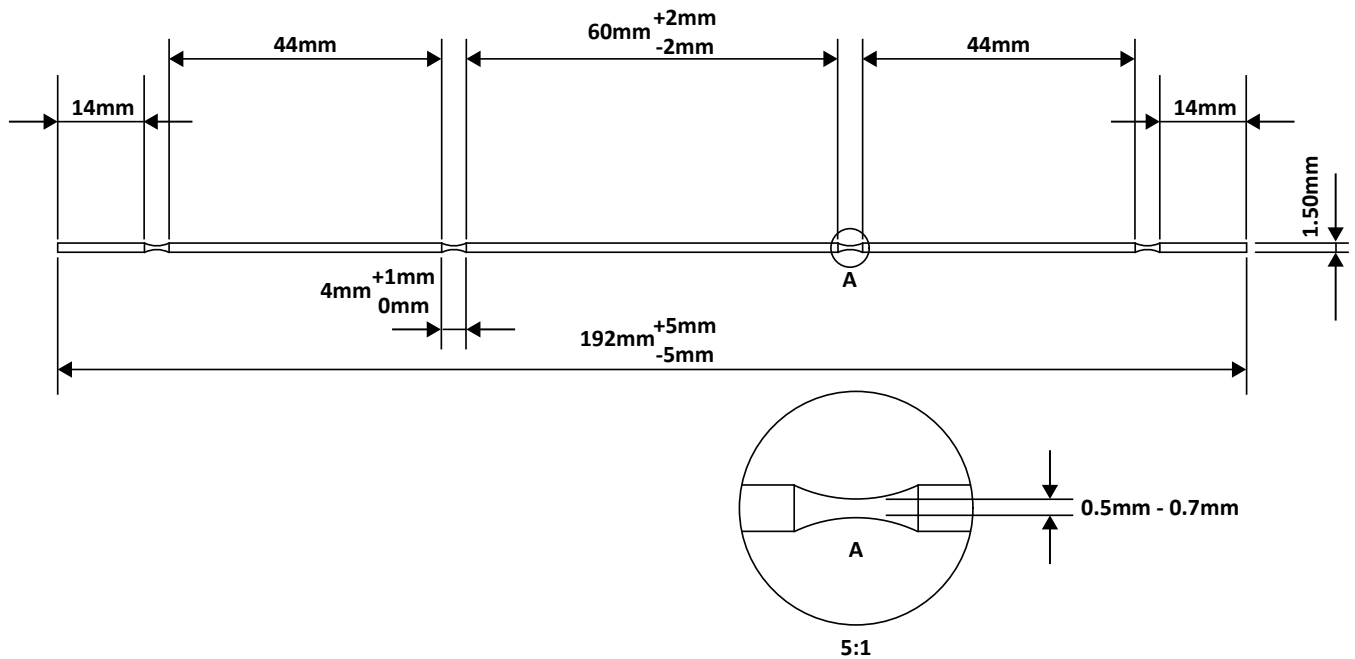

Astro FingerKeeper Commercial Front **Wide** measurements - Length 4 panel (in mm):

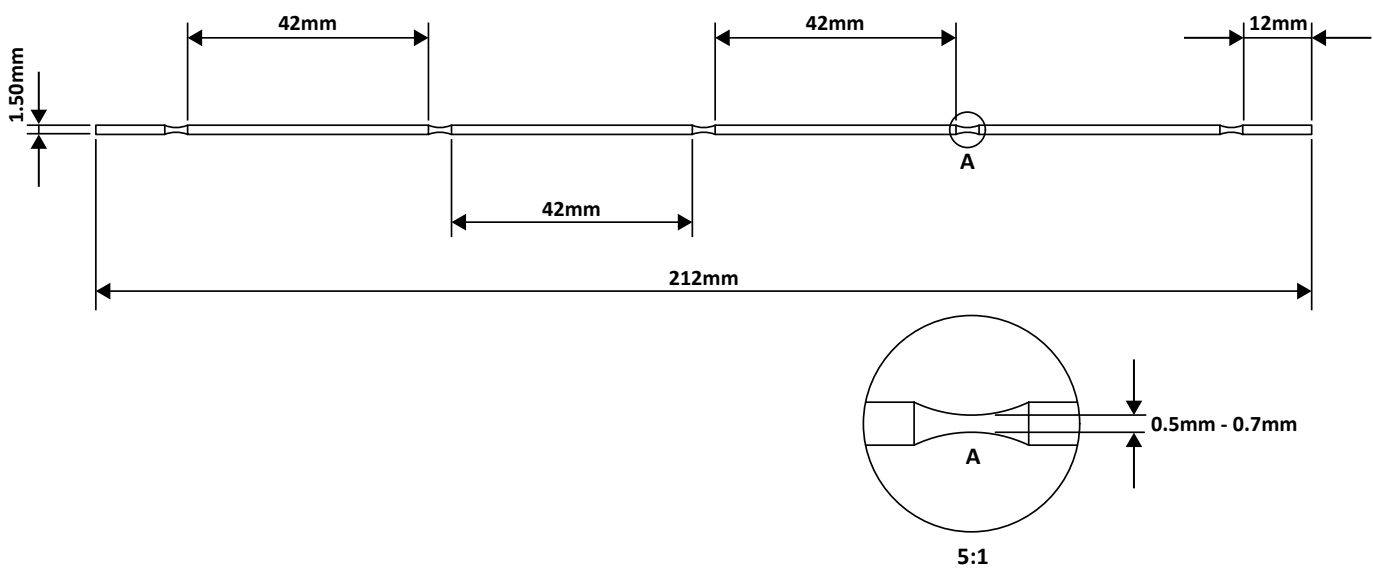

Product Availability

Front hinge cover versions available in 1960mm standard length and in a range of colours.

Wide Version: The 4 panel Wide version, with an extra centre panel, is specifically designed to be used on uPVC and aluminium doors and also on wooden doors which open up to 180 degrees.

Long Version: 2100mm Longer version available.

Note: The Wide and Long version are available in White or Brown only.



WHITE (9010)



BROWN (8016)



BEECH (1001)



BEIGE (1015)



BLACK (9005)



GREY (7040)



BLUE (5012)



ANTHRACITE GREY (7016)

Standard Length 3 panel			
Product Code	Description	Size	Colour
AFFKWH	Astro FingerKeeper Commercial Front	1960mm	White
AFFKBR	Astro FingerKeeper Commercial Front	1960mm	Brown
AFFKBEE	Astro FingerKeeper Commercial Front	1960mm	Beech
AFFKBEI	Astro FingerKeeper Commercial Front	1960mm	Beige
AFFKBLK	Astro FingerKeeper Commercial Front	1960mm	Black
AFFKGR	Astro FingerKeeper Commercial Front	1960mm	Grey
AFFKBLU	Astro FingerKeeper Commercial Front	1960mm	Blue
AFFKANT	Astro FingerKeeper Commercial Front	1960mm	Anthracite Grey

Longer Length 3 panel			
Product Code	Description	Size	Colour
AFFKWHL	Astro FingerKeeper Commercial Front - Long	2100mm	White
AFFKBRL	Astro FingerKeeper Commercial Front - Long	2100mm	Brown

Standard Length 4 panel			
Product Code	Description	Size	Colour
AFFKWHX	Astro FingerKeeper Commercial Front - Wide	1960mm	White
AFFKBRX	Astro FingerKeeper Commercial Front - Wide	1960mm	Brown

To Order & Specify

Please contact us and quote the following information - Quantity / Product Description / Product Code / Colour / Size
Typical wording - 10no / Astro FingerKeeper Commercial Front / AFFKWH / White / 1960mm

>> Tel: [01329 844 500](tel:01329844500) or >> Email: sales@astroflame.com

Health and Safety

For further information on health and safety requirements please contact the technical team on: tel [01329 844 500](tel:01329844500)
or email sales@astroflame.com

Installation

For further information on installation please see the installation sheet or video or contact the technical team
on: tel [01329 844 500](tel:01329844500) or email sales@astroflame.com

As part of our policy of ongoing improvements, we reserve the right to modify, alter or change product specifications without giving notice. Product illustrations are representations only. All information contained in this document is provided for guidance only, and as ASTROFLAME (FIRE SEALS) LTD has no control over the specific application or installation methods of the products, or of the prevailing site conditions, no warranties expressed or implied are intended to be given as to the actual performance of the products mentioned or referred to, and no liability whatsoever will be accepted for any loss, damage or injury arising from the use of the information given of products mentioned or referred to herein.

The above information to the best of our knowledge is true and accurate and based upon current test data and is supplied for your guidance only. Customers should satisfy themselves to the suitability of the product based on the products limitation of applications and that the product is fit for purpose for their intended use and no guarantee is given or implied since the conditions of actual use are beyond our control. ASTROFLAME (FIRE SEALS) LTD, disclaim any liability for loss, damage or other expense arising from the use of information, data or products mentioned or referred to and reserve the right to change any details or specifications without notice. If you are in any doubt as to the suitability of this product for your intended application please contact our technical team on 01329 844500 or email sales@astroflame.com and we will contact you.