

INSTALLATION INSTRUCTIONS FOR THE MANUAL CALL POINT X(R), X(R)B, X(R)L, X(R)LB, XS, XD

TO TEST

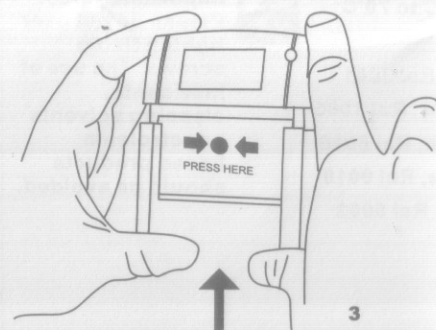

TO REPLACE GLASS / RESETTABLE ELEMENT

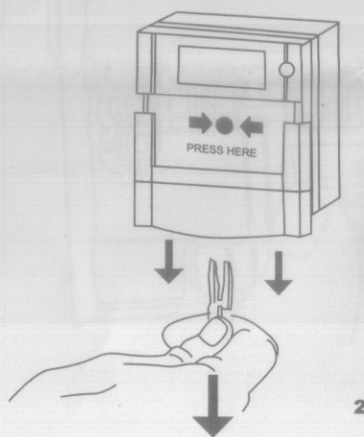
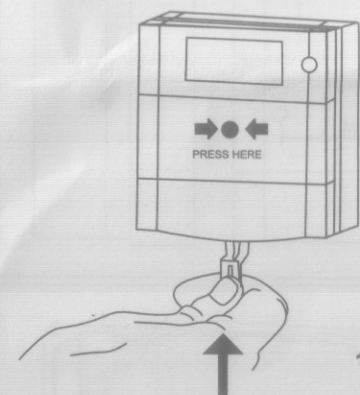
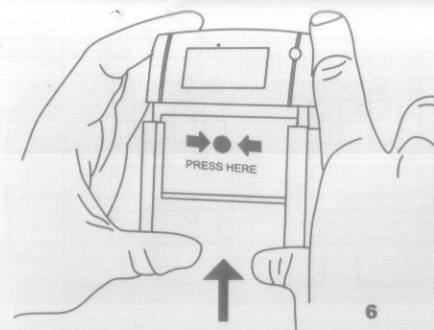
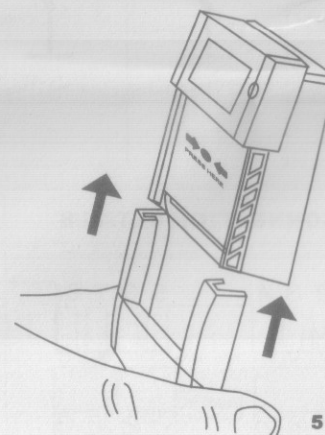
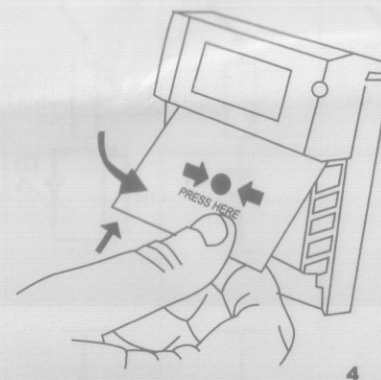
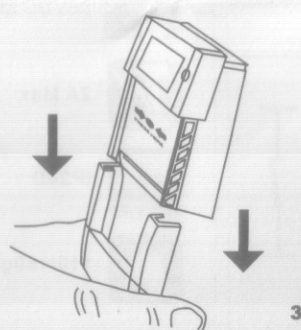
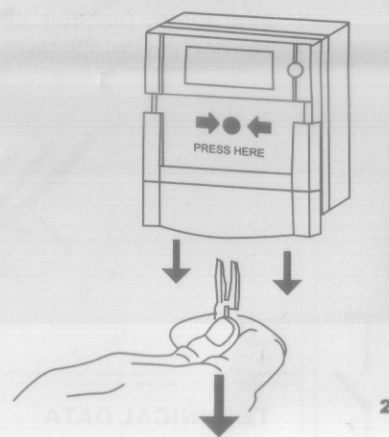
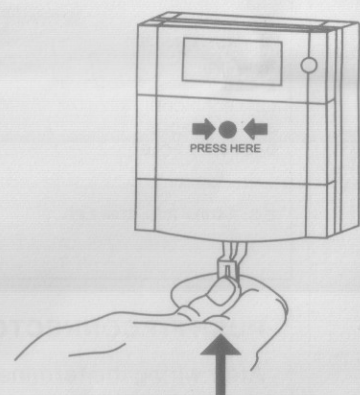

TO RESET

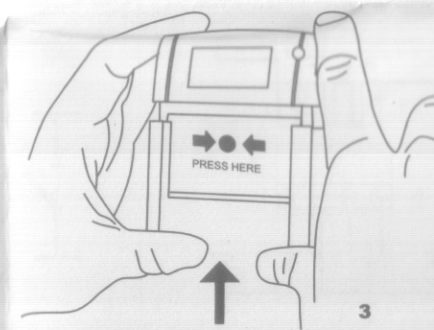
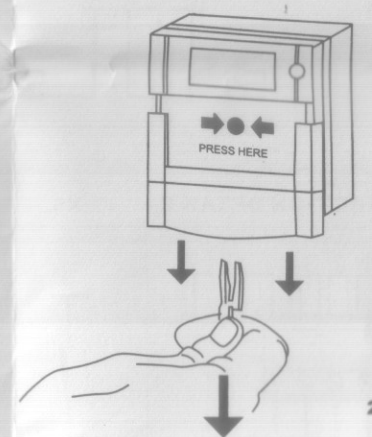
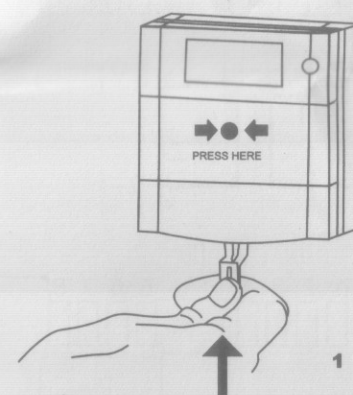

INSTALLATION INSTRUCTIONS FOR THE MANUAL CALL POINT X(R), X(R)B, X(R)L, X(R)LB, XS, **XD**

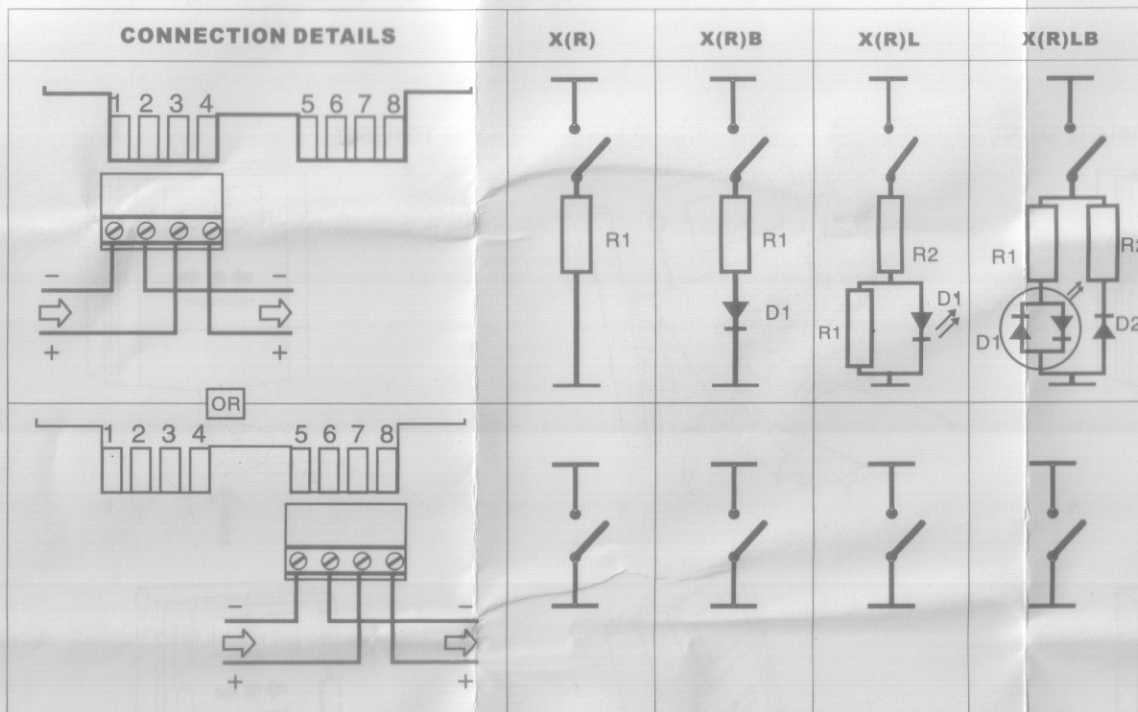

The code is designed to help in the selection of correct unit. The code means as below:

X--COLOR
(R)-- RESISTANCE
B--DIODE
L--LED
LB--LED&DIODE
S--SINGLE POLE
D--DOUBLE POLE

E.G: R470L= RED, 470R,LED

DIMENSIONS

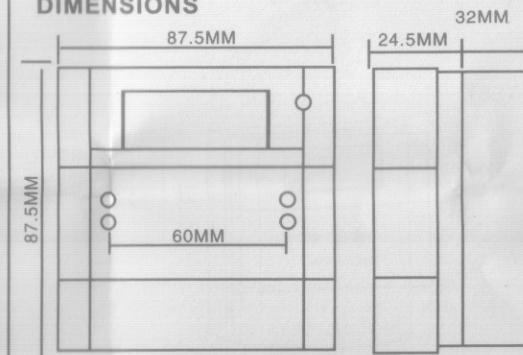

PUSH FIT CONNECTOR

After wiring the terminal connector, plug into the appropriate position, see connection details (left).

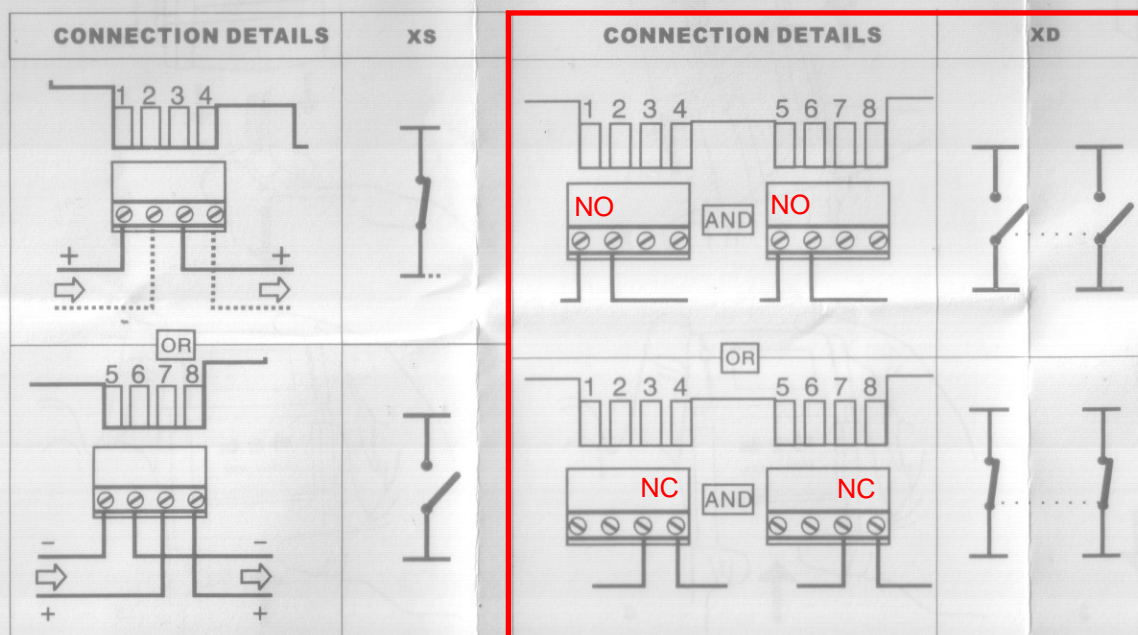
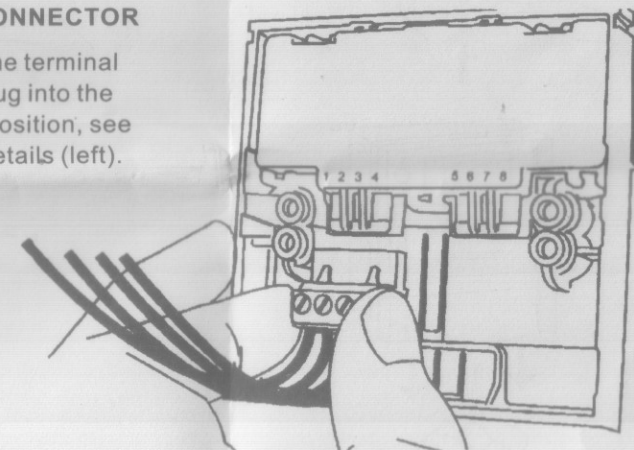

TECHNICAL DATA



30VDC Max



2A Max



IP24D



110/160g



-30°C to 70°C



Red, Ral 3001
Yellow, Ral 1006
Green, Ral 6016
White, Ral 9010
Blue, Ral 5002



Important Notes:
Please do not over tighten fixing screws. The use of lubricants, cleaning solvents or petroleum based products should be avoided.